

D16FC-FBA-F4/F5

PN16

DN50~200

SPECIFICATION

FULL BORE · PTFE SEAT

CONFORMS TO DIN 3202 F4 / F5 SERIES

FLANGED TO DIN 2533 PN16

PRESSURE / TEMPERATURE RATINGS

Working Pressure	16 bar
Testing Pressure	Shell : 24 bar Seat : 17.6 bar
Working Temperature	-20 °C to 150 °C
Suitable Media	Water, Oil & Steam

MATERIALS

Part	Material	DIN
Body	Cast Iron	GG25
Bonnet	Cast Iron	GG25
Ball	Stainless Steel 304	X5CrNi189
Seat	PTFE	
Shaft	Stainless Steel 420	X20Cr13
Handle	Cast Iron (DN50~80) Steel (DN100~200)	GG25

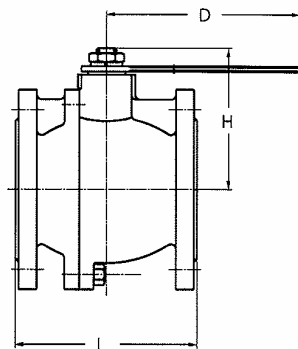

(DN50~80)

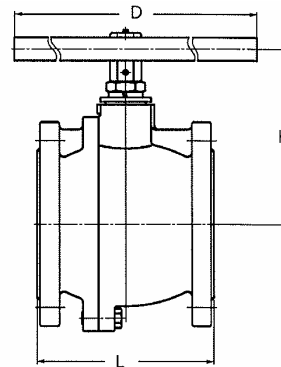

(DN100~200)

DIMENSIONS

Size mm	L mm	H mm	D mm
50	150	123	165
65	170	145	185
80	180	149	200
100	190	190	220
125	325	211	250
150	350	243	285
200	400	275	340

Note:

- Other specifications and flange standards are available upon request.
- Design and specifications are subject to change without prior notice.